

# Instruction Manual

*for*

**POWER  HAND<sup>®</sup> 2X**

**Swing Head Assembly  
Model: Z-SWX**

**#510-2256**

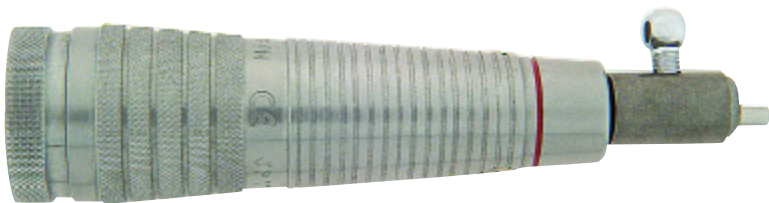

**Gesswein<sup>®</sup>**

The Right Tools

# Introduction

The Gesswein Power Hand 2X Z-SWX Head Assembly is engineered and manufactured to a high degree of precision and will give you many years of trouble-free service. Backed by a limited warranty that covers wear parts for 90 days and overall balance of parts for six months.

This Head Assembly is designed to be used on Power Hand 2X motors in conjunction with Power Hand 2X Single, Standard, Dual, Jewelers' Micromotor, Power Carver II and Bright-Cutting Controllers. These controllers convert the Alternating Current (AC) power supply to a variable Direct Current (DC) by means of an I.C. "transistorized" automatically controlled circuit.

The Gesswein Power Hand 2X handpiece series consists of nine models and eleven head assemblies with maximum operating speeds ranging from 8,000 to 55,000rpm and 0 to 117 strokes per second. All models are identified by their names, which are engraved on the motor housings.



# 1. Accessories

## Included Accessories

- A. One Allen Wrench
- B. One Tool Pin

## Optional Accessories

- A. Handpiece Extension Cord (#510-1120): adds 6', or almost 2m, to the 1.7m handpiece cord
- B. Handpiece Cradle Rest (#510-1130): provides safe holding place for handpiece when not in use
- C. Variable-Speed Foot Rheostat (#510-3100)
- D. On/Off Foot Switch (#510-3105)

# 2. Parts Nomenclature

- 1. Swing Arm (Tool Holder)
- 2. Swing Arm Pivot Point (indicated by a red ring)
- 3. Top Cover

4. Knurled Ring

5. Motor Cover

6. Electric Cord with 3-Pin Plug

7. Main Eccentric Shaft

8. Stroke Adjustment Screw

9. Knurled Adjusting Ring

10. Drive Bearing

11. Tool-Securing Screw

12. Motor Connecting Ring

13. Nylon Drive Shoe

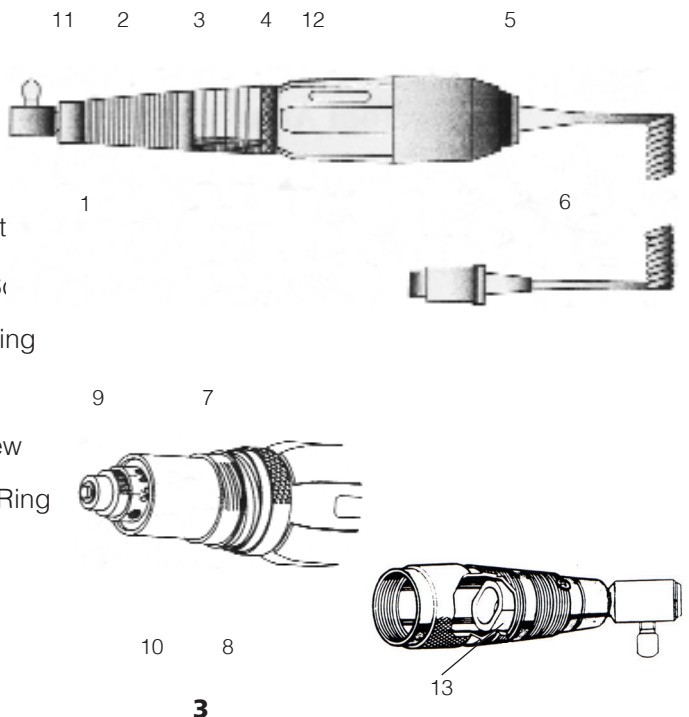

### 3. Stroke Adjustment

The SZX Profiler has an adjustable stroke of 0-1.6mm, measured at the Tool Holder. However, the stroke will be greater at the tool end. To adjust stroke, first remove the Top Cover by firmly grasping the Knurled Ring (see fig. 2) and unscrewing in a counterclockwise direction. Completely remove the Top Cover from the handpiece motor. Next, loosen the Hex Socket Set Screw (see fig. 3) located on the side of the main eccentric shaft using the Allen Wrench provided. Now line up the mark on the Knurled Adjusting Ring with the stroke setting marked in millimeters on the side of the main shaft. Finally, tighten the Hex Socket Set Screw, and firmly secure the handpiece Top Cover to the motor by screwing in a clockwise direction.

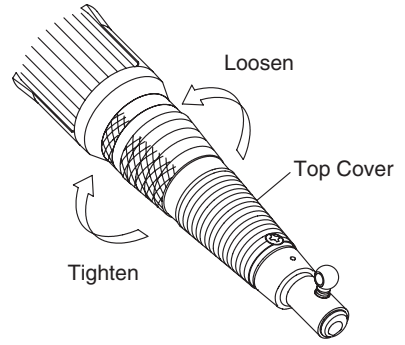

**Fig. 2**

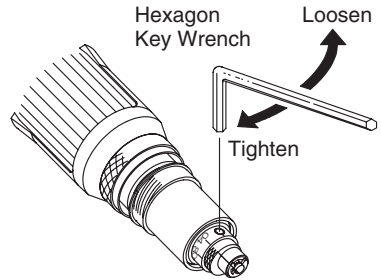

**Fig. 3**

### 4. Tool Attachment

Loosen the Tool-Securing Screw located on the Swing Arm (Tool Holder) using the Tool Pin Provided. Place the tool into the Tool Holder, and fasten securely (see fig. 4).

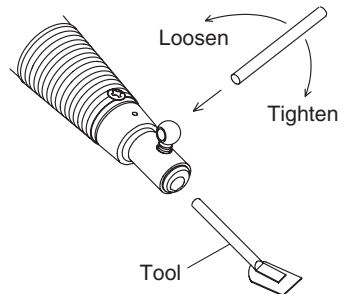

**Fig. 4**

## 5. Operating Procedure

With your SZX Profiler adjusted for stroke and with a selected tool fitted, connect the Gesswein Power Hand Controller to an electrical supply and the profiler to controller.

Set the Slide Rheostat on the Controller to “Low” or the “0” position. Put the Controller Main Switch to the “ON” position, which lights up a pilot light that indicates your SZX Profiler is ready to use.

To increase the speed of the SZX Profiler, move the Slide Rheostat toward High or “10” and the desired reciprocating frequency. You can now begin working. When work is completed, put the Main Switch to “OFF.”

To operate your handpiece using the optional Variable-Speed Foot Rheostat or optional On/Off Foot Switch, please refer to the Power Hand 2X Controller Instruction Manual for proper connection. The handpiece will not run until the foot rheostat/switch is depressed. The rheostat provides infinitely variable speed control; the switch only turns handpiece on and off (operates at speed selected on control unit).



## Z-SWX Parts List

When ordering spare parts, always specify part# (or item# if applicable) and description.

<b>Part#</b>	<b>Item#</b>	<b>Description</b>
Z-SWX-101	<b>8960230</b>	Top Cover
Z-SWX-102	<b>8960231</b>	Oval Countersunk Set Screw
Z-SWX-200	<b>8960232</b>	Swing Arm Complete
Z-SWX-201	<b>8960233</b>	Swing Arm Support B
Z-SWX-202	<b>8960234</b>	Swing Arm
Z-SWX-203	<b>8960235</b>	Tool-Securing Screw
Z-SWX-204	<b>8960236</b>	Swing Arm Support A
Z-SWX-300		Eccentric Shaft Complete
Z-SWX-301	<b>8960156</b>	E-Type Clip Ring
Z-SWX-302	<b>5103076</b>	Ball Bearing
Z-SWX-303	<b>8960238</b>	Eccentric Shaft
Z-SWX-400	<b>8960241</b>	Main Shaft Complete
Z-SWX-401	<b>8960242</b>	Main Shaft
Z-SWX-402	<b>8960067</b>	Coil Spring
Z-SWX-403	<b>5100151</b>	Nylon Coupler (Joint)
Z-SWX-404	<b>8960068</b>	C-Type Clip
Z-SWX-405	<b>8960243</b>	Teflon Spacer
Z-SWX-406	<b>5103079</b>	Ball Bearing
Z-SWX-407	<b>8960244</b>	O-Type Rubber Ring
Z-SWX-408	<b>8960245</b>	Bearing Spacer
Z-SWX-409	<b>8960246</b>	C-Type Clip Ring
Z-SWX-420	<b>8960240</b>	Hexagon Socket Set Screw
Z-SWX-501	<b>8960239</b>	C-Type Clip Ring
Z-SWX-502	<b>8960247</b>	Wave Washer
Z-SWX-503	<b>8960248</b>	Lock Ring Completed
Z-SWX-002	<b>8960249</b>	Hexagon Key Wrench

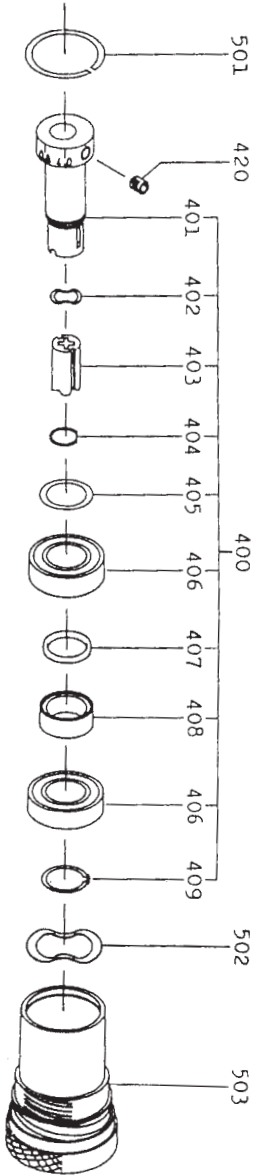
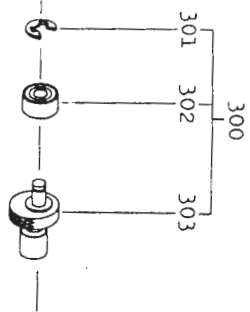
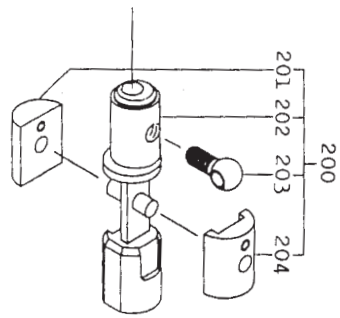
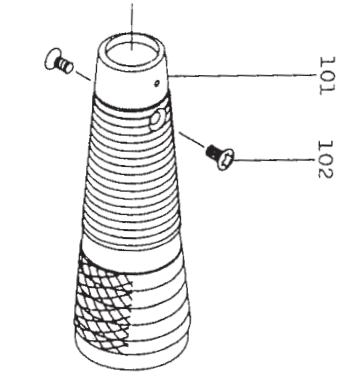



Power Hand 2X controllers and handpieces combine to create the most versatile finishing system in the industry, offering rotary, profiling and belt sanding action.

### **Power Hand 2X component selection:**

- Three controllers
- Six straight (four standard, two slimline) and two angle rotaries
- Two reciprocating profilers
- One side-to-side profiler
- One belt sander
- One 4:1 reduction gear
- Separate motors and handpiece heads

**Safety Recommendations** — Prolonged use of vibrating or reciprocating tools may result in vibration-induced circulation problems in the hands. Always follow safe operating procedures. Using hand protection (i.e., insulated gloves) and taking frequent breaks can help minimize but not guarantee against injury. Operating these types of tools in cold weather or with a tight grip will reduce the period of operation before risking potential injury. Individuals with a tendency to suffer from poor circulation, frequently cold fingers or itchy hands should closely monitor the condition of their hands. If symptoms appear, seek medical advice immediately.



201 Hancock Ave., Bridgeport, CT 06605, USA

☎ 203-366-5400 FAX 203-366-3953 Order toll-free 800-243-4466

Web site: [www.gesswein.com](http://www.gesswein.com) E-mail: [info@gesswein.com](mailto:info@gesswein.com)